

TANK-AXONOMETRIC

TANK COMPONENTS

No.	Description	Material	Qty	Remarks
1	Water tank	FRP	1	Colour GRAY
2	Manhole Cover	FRP	1	S/S Hinges & Locks
3	Internal Ladder	SS	1	Height : 2.5m
4	External Ladder	G.I.	1	Height : 2.5m
5	Air vent	PVC	1	Light & Insect Proof 4" Bowl Type
6	Inlet	-	1	2" Connection Flange
7	Outlet	-	1	2.5" Connection Flange
8	Drainage	-	1	2" Connection Flange
9	Overflow	-	1	3" Connection Flange
10	Control	-	1	3" Connection Flange
11	Water Level Indicator	C&M	1	Height : 2.5m
12	Vortex Assembly	PVC	1	2.5" Anti-Vortex Plate
13	Side Manway	FRP	1	-

NOTES:

CAUTIONS

1. Allow a minimum space of 50 cm all around the tank's foundation.
2. Maximum allowable deflection in concrete foundation = +/- 2mm.
3. For sizes of items 6, 7, 8, 9 & 10, please refer to catalogue.
4. FTC will not be held liable if the erection of our water tanks are not made in accordance to the technical requirements of concrete foundation, steel footing and water tank assembly drawings.
5. Overflow shall be minimum twice the volume of inlet.
6. Overflow shall flow freely to the ground.
7. All tanks shall be electrically grounded.

GRP Panel Type Water Tanks  
Seismic Load Kh=0.3G

Tank size:	3.28 x 3.28x 8.2 ft High.			
	1x1x2.5 m HIGH			
Volume:	2.5	660	550	
	m <sup>3</sup>	USG	ImpG	
Bolts / Nuts:	S/S A4 - 316			
Insulation:	Non-Insulated			

Project Name:

5821  
Southwest Freeway

Contractor:

Cougar USA

Consultant:

-

Done By:	JC	Reviewed by:	
		Verified by:	-

Revisions

No.	Issue Date	Description
0	12Aug'21	NEW

**FTC** FIBER TECHNOLOGY CORPORATION  
Head Office:  
Lorton, Virginia, United States of America  
Regional Office:  
Jebel Ali Free Zone, Dubai, U.A.E.

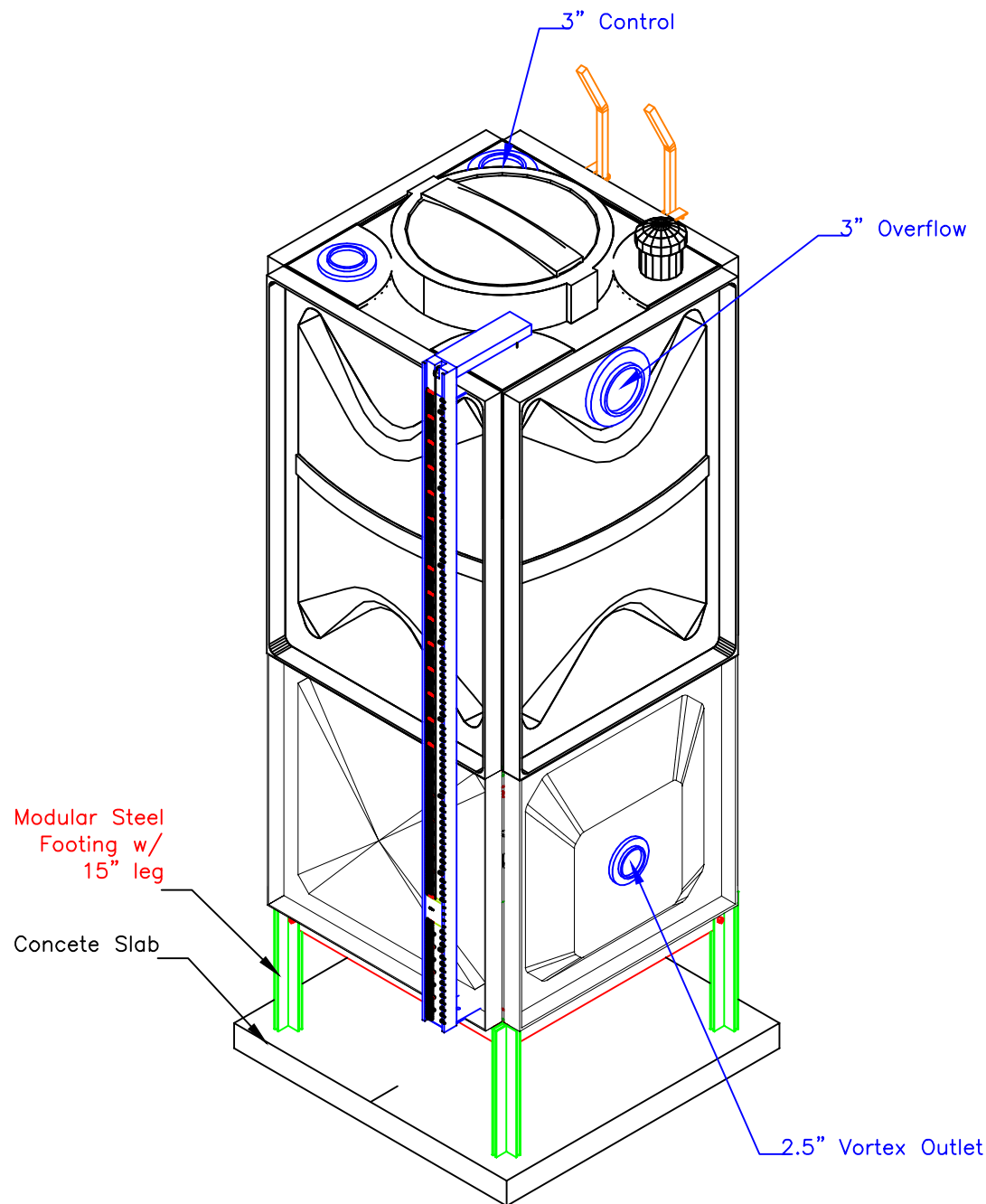

TANK-AXONOMETRIC

TANK COMPONENTS

No.	Description	Material	Qty	Remarks
1	Water tank	FRP	1	Colour GRAY
2	Manhole Cover	FRP	1	S/S Hinges & Locks
3	Internal Ladder	SS	1	Height : 2.5m
4	External Ladder	G.I.	1	Height : 2.5m
5	Air vent	PVC	1	Light & Insect Proof 4" Cowl Type
6	Inlet	-	1	2" Connection Flange
7	Outlet	-	1	2.5" Connection Flange
8	Drainage	-	1	2" Connection Flange
9	Overflow	-	1	3" Connection Flange
10	Control	-	1	3" Connection Flange
11	Water Level Indicator	C&M	1	Height : 2.5m
12	Vortex Assembly	PVC	1	2.5" Anti-Vortex Plate
13	Side Manway	FRP	1	-

NOTES:

CAUTIONS

1. Allow a minimum space of 50 cm all around the tank's foundation.
2. Maximum allowable deflection in concrete foundation = +/- 2mm.
3. For sizes of items 6, 7, 8, 9 & 10, please refer to catalogue.
4. FTC will not be held liable if the erection of our water tanks are not made in accordance to the technical requirements of concrete foundation, steel footing and water tank assembly drawings.
5. Overflow shall be minimum twice the volume of inlet.
6. Overflow shall flow freely to the ground.
7. All tanks shall be electrically grounded.

GRP Panel Type Water Tanks

Seismic Load Kh=0.3G

Tank size:	3.28 x 3.28x 8.2 ft High.			
	1x1x2.5 m HIGH			
Volume:	2.5	660	550	
	m <sup>3</sup>	USG	ImpG	
Bolts / Nuts:	S/S A4 - 316			
Insulation:	Non-Insulated			

Project Name:

5821  
Southwest Freeway

Contractor:

Cougar USA

Consultant:

-

Done By:	JC	Reviewed by:	
		Verified by:	-

Revisions

No.	Issue Date	Description
0	12Aug'21	NEW

**FTC** FIBER TECHNOLOGY CORPORATION

Head Office:  
Lorton, Virginia, United States of America  
Regional Office:  
Jebel Ali Free Zone, Dubai, U.A.E.



FINISHED FLOOR LEVEL (CONCRETE SLAB)

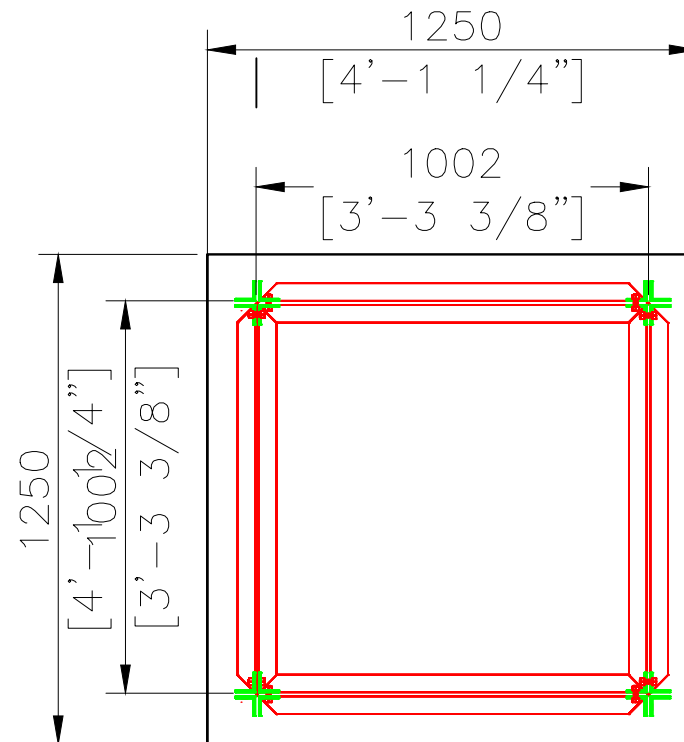

TANK COMPONENTS			
No.	Description	Material	Qty/Remarks
1	Water tank	FRP	1 Colour GRAY
2	Manhole Cover	FRP	1 S/S Hinges & Locks
3	Internal Ladder	SS	1 Height : 2.5m
4	External Ladder	G.I.	1 Height : 2.5m
5	Air vent	PVC	1 Light & Insect Proof 4" Cowl Type
6	Inlet	-	1 2" Connection Flange
7	Outlet	-	1 2.5" Connection Flange
8	Drainage	-	1 2" Connection Flange
9	Overflow	-	1 3" Connection Flange
10	Control	-	1 3" Connection Flange
11	Water Level Indicator	C&M	1 Height : 2.5m
12	Vortex Assembly	PVC	1 2.5" Anti-Vortex Plate
13	Side Manway	FRP	1 -

- NOTES:
- CAUTIONS
1. Allow a minimum space of 50 cm all around the tank's foundation.

2. Maximum allowable deflection in concrete foundation = +/- 2mm.

3. For sizes of items 6, 7, 8, 9 & 10, please refer to catalogue.

4. FTC will not be held liable if the erection of our water tanks are not made in accordance to the technical requirements of concrete foundation, steel footing and water tank assembly drawings.

5. Overflow shall be minimum twice the volume of inlet.

6. Overflow shall flow freely to the ground.

7. All tanks shall be electrically grounded.

GRP Panel Type Water Tanks			
Seismic Load Kh=0.3G			
Tank size:	3.28 x 3.28x 8.2 ft High. 1x1x2.5 m HIGH		
Volume:	2.5 m <sup>3</sup>	660 USG	550 ImpG
Bolts / Nuts:	S/S A4 - 316		
Insulation:	Non-Insulated		

Project Name:

5821  
Southwest Freeway

Contractor:

Cougar USA

Consultant:

-

Done By:	JC	Reviewed by:	
		Verified by:	-
Revisions			
No.	Issue Date	Description	
0	12Aug'21	NEW	

FTC

FIBER TECHNOLOGY CORPORATION

Head Office:  
Lorton, Virginia, United States of America

Regional Office:  
Jebel Ali Free Zone, Dubai, U.A.E.

STEEL-ELEVATION

STEEL PLAN

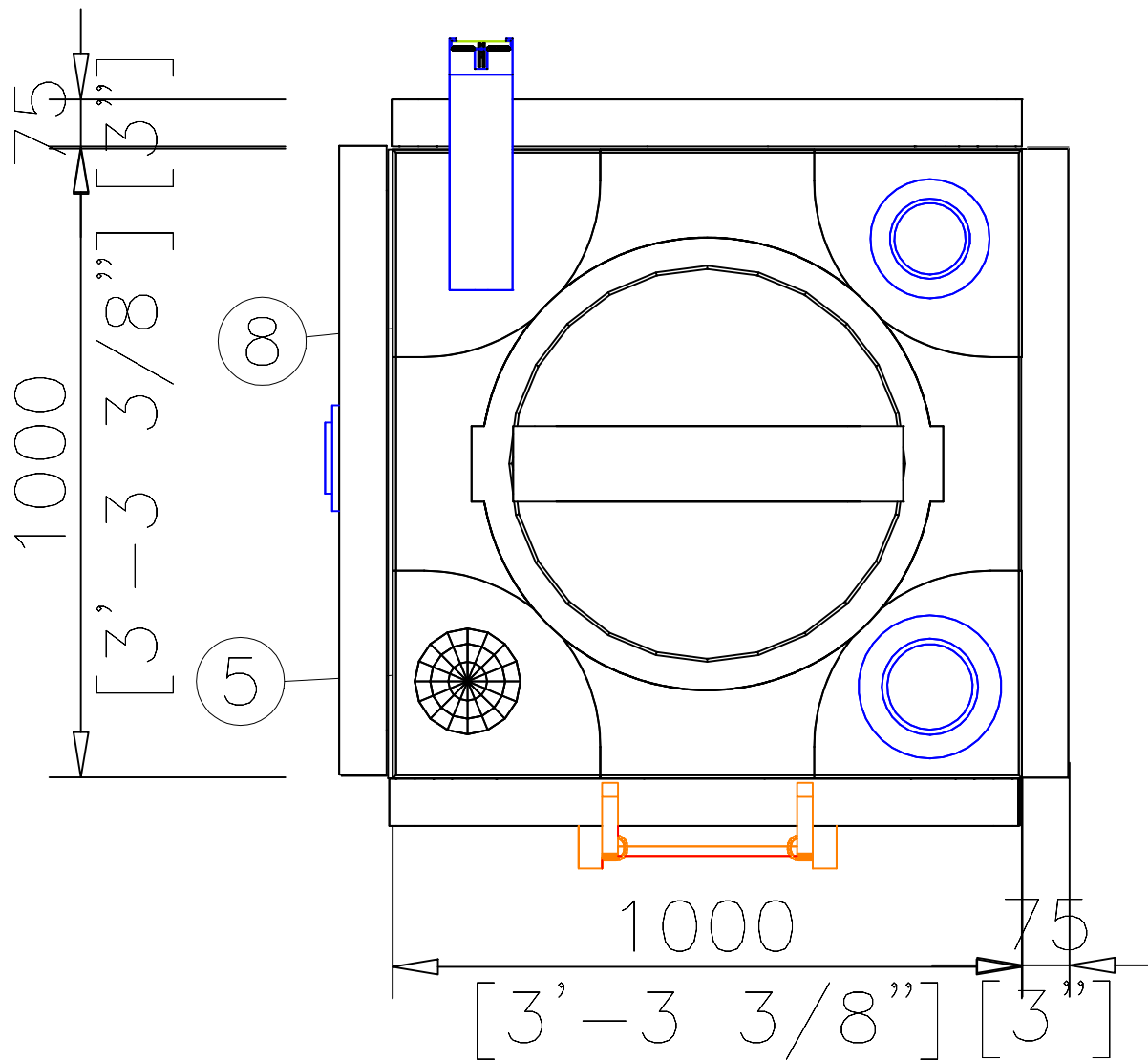

TANK-PLAN

TANK COMPONENTS			
No.	Description	Material	Qty/Remarks
1	Water tank	FRP	1 Colour GRAY
2	Manhole Cover	FRP	1 S/S Hinges & Locks
3	Internal Ladder	SS	1 Height : 2.5m
4	External Ladder	G.I.	1 Height : 2.5m
5	Air vent	PVC	1 Light & Insect Proof 2' Cow Type
6	Inlet	-	1 2" Connection Flange
7	Outlet	-	1 2.5" Connection Flange
8	Drainage	-	1 2" Connection Flange
9	Overflow	-	1 3" Connection Flange
10	Control	-	1 3" Connection Flange
11	Water Level Indicator	C&M	1 Height : 2.5m
12	Vortex Assembly	PVC	1 2.5" Anti-Vortex Plate
13	Side Manway	FRP	1 -

- NOTES:
- CAUTIONS
- Allow a minimum space of 50 cm all around the tank's foundation.
  - Maximum allowable deflection in concrete foundation = +/- 2mm.
  - For sizes of items 6, 7, 8, 9 & 10, please refer to catalogue.
  - FTC will not be held liable if the erection of our water tanks are not made in accordance to the technical requirements of concrete foundation, steel footing and water tank assembly drawings.
  - Overflow shall be minimum twice the volume of inlet.
  - Overflow shall flow freely to the ground.
  - All tanks shall be electrically grounded.

GRP Panel Type Water Tanks			
Seismic Load Kh=0.3G			
Tank size:	3.28 x 3.28x 8.2 ft High. 1x1x2.5 m HIGH		
Volume:	2.5 m³	660 USG	550 ImpG
Bolts / Nuts:	S/S A4 - 316		
Insulation:	Non-Insulated		

Project Name:

5821  
Southwest Freeway

Contractor:

Cougar USA

Consultant:

-

Done By:	JC	Reviewed by:	
		Verified by:	-
Revisions			
No.	Issue Date	Description	
0	12Aug21	NEW	

**FTC**

FIBER TECHNOLOGY CORPORATION

Head Office:  
Lorton, Virginia, United States of America

Regional Office:  
Jebel Ali Free Zone, Dubai, U.A.E.

FRONT ELEVATION

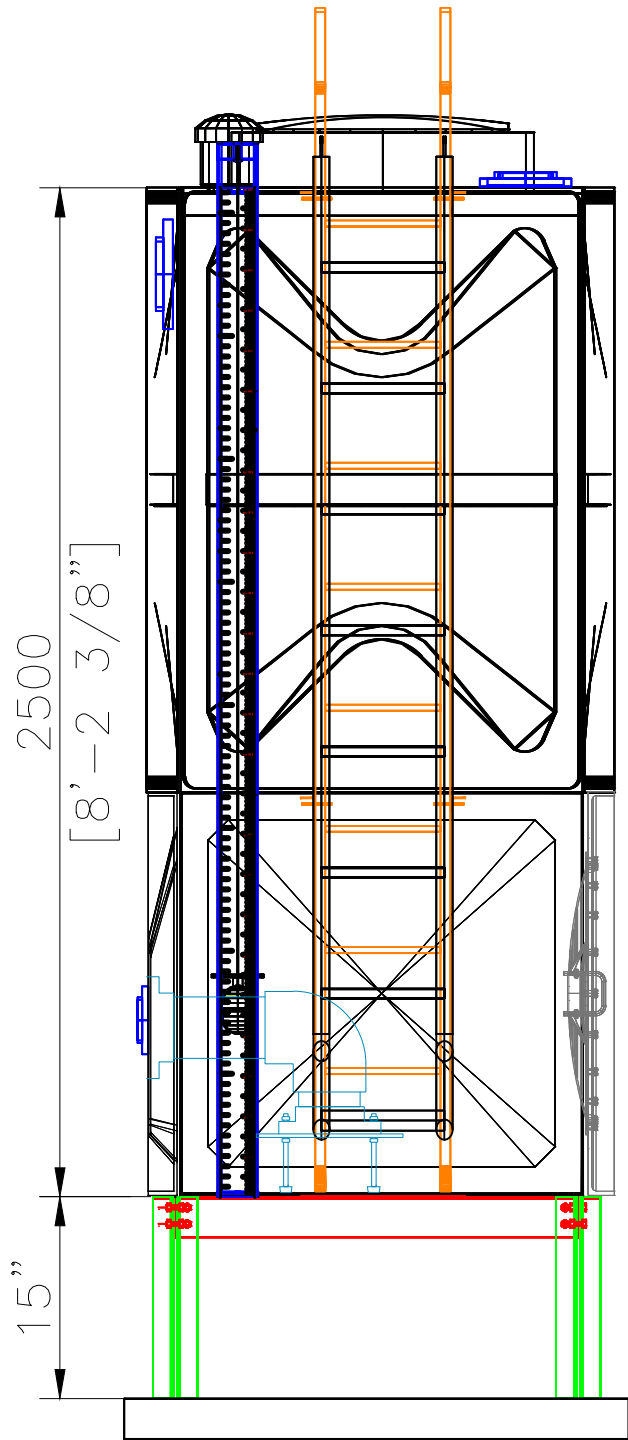

TANK COMPONENTS			
No.	Description	Material	Qty/Remarks
1	Water tank	FRP	1 Colour GRAY
2	Manhole Cover	FRP	1 S/S Hinges & Locks
3	Internal Ladder	SS	1 Height : 2.5m
4	External Ladder	G.I.	1 Height : 2.5m
5	Air vent	PVC	1 Light & Insect Proof 4" Cowl Type
6	Inlet	-	1 2" Connection Flange
7	Outlet	-	1 2.5" Connection Flange
8	Drainage	-	1 2" Connection Flange
9	Overflow	-	1 3" Connection Flange
10	Control	-	1 3" Connection Flange
11	Water Level Indicator	C&M	1 Height : 2.5m
12	Vortex Assembly	PVC	1 2.5" Anti-Vortex Plate
13	Side Manway	FRP	1 -

- NOTES:
- CAUTIONS
- Allow a minimum space of 50 cm all around the tank's foundation.
  - Maximum allowable deflection in concrete foundation = +/- 2mm.
  - For sizes of items 6, 7, 8, 9 & 10, please refer to catalogue.
  - FTC will not be held liable if the erection of our water tanks are not made in accordance to the technical requirements of concrete foundation, steel footing and water tank assembly drawings.
  - Overflow shall be minimum twice the volume of inlet.
  - Overflow shall flow freely to the ground.
  - All tanks shall be electrically grounded.

GRP Panel Type Water Tanks			
Seismic Load Kh=0.3G			
Tank size:	3.28 x 3.28x 8.2 ft High. 1x1x2.5 m HIGH		
Volume:	2.5 m³	660 USG	550 ImpG
Bolts / Nuts:	S/S A4 - 316		
Insulation:	Non-Insulated		

Project Name:

5821  
Southwest Freeway

Contractor:

Cougar USA

Consultant:

-

Done By:	JC	Reviewed by:	
		Verified by:	-
Revisions			
No.	Issue Date	Description	
0	12Aug'21	NEW	

FTC

FIBER TECHNOLOGY CORPORATION

Head Office:  
Lorton, Virginia, United States of America

Regional Office:  
Jebel Ali Free Zone, Dubai, U.A.E.

Copyright Fiber Technology Corporation

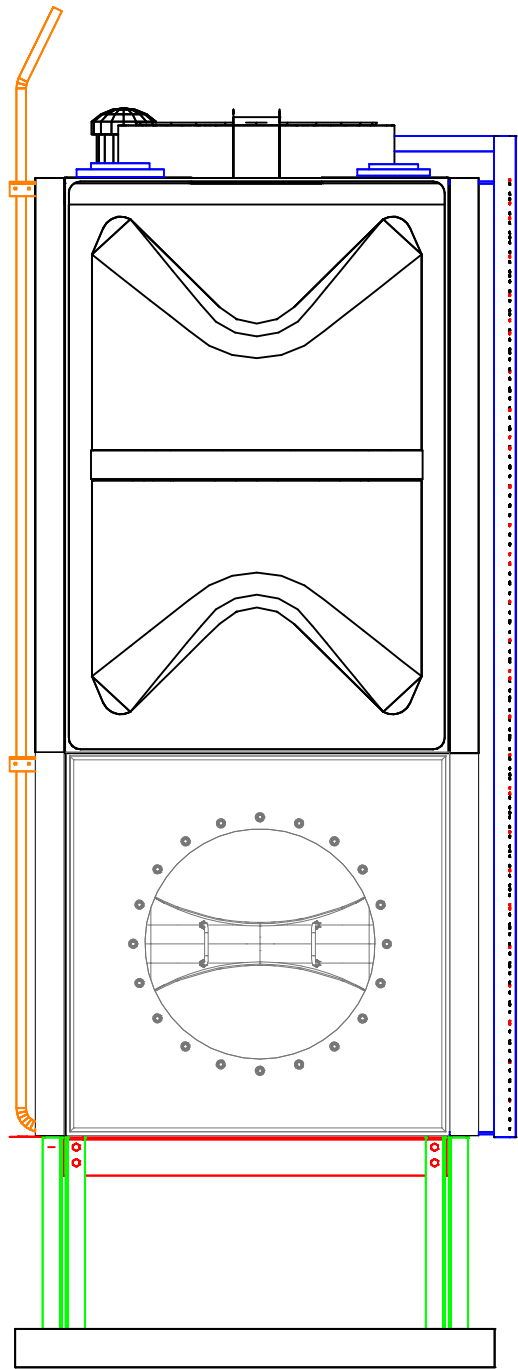

TANK-RIGHT ELEVATION

TANK COMPONENTS			
No.	Description	Material	Qty/Remarks
1	Water tank	FRP	1 Colour GRAY
2	Manhole Cover	FRP	1 S/S Hinges & Locks
3	Internal Ladder	SS	1 Height : 2.5m
4	External Ladder	G.I.	1 Height : 2.5m
5	Air vent	PVC	1 Light & Insect Proof 2' Cowl Type
6	Inlet	-	1 2' Connection Flange
7	Outlet	-	1 2.5' Connection Flange
8	Drainage	-	1 2' Connection Flange
9	Overflow	-	1 3' Connection Flange
10	Control	-	1 3' Connection Flange
11	Water Level Indicator	C&M	1 Height : 2.5m
12	Vortex Assembly	PVC	1 2.5' Anti-Vortex Plate
13	Side Manway	FRP	1 -

NOTES:		CAUTIONS
1. Allow a minimum space of 50 cm all around the tank's foundation.		
2. Maximum allowable deflection in concrete foundation = +/- 2mm.		
3. For sizes of items 6, 7, 8, 9 & 10, please refer to catalogue.		
4. FTC will not be held liable if the erection of our water tanks are not made in accordance to the technical requirements of concrete foundation, steel footing and water tank assembly drawings.		
5. Overflow shall be minimum twice the volume of inlet.		
6. Overflow shall flow freely to the ground.		
7. All tanks shall be electrically grounded.		

GRP Panel Type Water Tanks			
Seismic Load Kh=0.3G			
Tank size:	3.28 x 3.28x 8.2 ft High. 1x1x2.5 m HIGH		
Volume:	2.5 m <sup>3</sup>	660 USG	550 ImpG
Bolts / Nuts:	S/S A4 - 316		
Insulation:	Non-Insulated		

Project Name:	5821 Southwest Freeway
Contractor:	Cougar USA
Consultant:	-

Done By:	JC	Reviewed by:	
		Verified by:	-
Revisions			
No.	Issue Date	Description	
0	12Aug'21	NEW	

<b>FTC</b> FIBER TECHNOLOGY CORPORATION	
Head Office:	
Lorton, Virginia, United States of America	
Regional Office:	
Jebel Ali Free Zone, Dubai, U.A.E.	